

NOTICE!!

These documents have been scanned!

Do not place un-scanned documents beneath this notice!

Do not remove this notice from this file!

GPO Jacket No. 560-102
Print Order 61540
Rise Business Services, LLC
Job=AZ15 5/10/2019



Box Number= AZ15031



Claim Begin-End: AMC429993-AMC429993

1 Initial Receipt



AZ15031-27

AMC429540-AMC429995

United States Department of the Interior
Bureau of Land Management
LANDS/RECREATION & PLANNING
ONE N CENTRAL AVE
PHOENIX, AZ 85004 -2203
Phone: 602-417-9200

Receipt

No: 3174196

Transaction #: 3267068	
Date of Transaction: 11/24/2014	
CUSTOMER:	
JEFF DUNKIN 12 FETTERS LN RIVERSIDE, WA 98849-9687 US	<i>RAM</i>

LINE #	QTY	DESCRIPTION	REMARKS	UNIT PRICE	TOTAL
1	1.00	LOCATABLE MINERALS / MINING CLAIMS- NEW, UNADJUD, ONE OR MORE AUTH NOS / NEW MINING CLAIMS LOCATION FEE CASES: AMC429993/\$37.00		- n/a -	37.00
2	1.00	LOCATABLE MINERALS / MINING CLAIMS- NEW, UNADJUD, ONE OR MORE AUTH NOS / NEW MINING CLAIM PROCESSING FEE CASES: AMC429993/\$20.00		- n/a -	20.00
3	1.00	LOCATABLE MINERALS / MINING CLAIMS- NEW, UNADJUD, ONE OR MORE AUTH NOS / NEW MINING CLAIMS MAINTENANCE FEE CASES: AMC429993/\$155.00		- n/a -	155.00
TOTAL:					\$212.00

PAYMENT INFORMATION			
1	AMOUNT:	212.00	POSTMARKED: N/A
	TYPE:	CASH	RECEIVED: 11/24/2014
	NAME:	DUNKIN, JEFF 12 FETTERS LN RIVERSIDE WA 98849-9687 US	

REMARKS

This receipt was generated by the automated BLM Collections and Billing System and is a paper representation of a portion of the official electronic record contained therein.

NOTICE!!

These documents have been scanned!

Do not place un-scanned documents beneath this notice!

Do not remove this notice from this file!

GPO Jacket No. 560-102
Print Order 61540
Rise Business Services, LLC
Job=AZ15 5/10/2019



Box Number= AZ15031



Claim Begin-End: AMC429993-AMC429993

2 Correspondence



AZ15031-27

AMC429540-AMC429995

**NO
DOCUMENTS
FOUND**

NO DOCUMENTS FOUND
NO DOCUMENTS FOUND

NOTICE!!

These documents have been scanned!

Do not place un-scanned documents beneath this notice!

Do not remove this notice from this file!

GPO Jacket No. 560-102
Print Order 61540
Rise Business Services, LLC
Job=AZ15 5/10/2019



Box Number= AZ15031



Claim Begin-End: AMC429993-AMC429993

3 Transfers



AZ15031-27

AMC429540-AMC429995

**NO
DOCUMENTS
FOUND**

NO DOCUMENTS FOUND
NO DOCUMENTS FOUND

NOTICE!!

These documents have been scanned!

Do not place un-scanned documents beneath this notice!

Do not remove this notice from this file!

GPO Jacket No. 560-102
Print Order 61540
Rise Business Services, LLC
Job=AZ15 5/10/2019



Box Number= AZ15031



Claim Begin-End: AMC429993-AMC429993

4 Annual Filings



AZ15031-27

AMC429540-AMC429995

DEPARTMENT OF THE INTERIOR
BUREAU OF LAND MANAGEMENT
MINING CLAIMS

Run Date/Time: 8/20/2018

MC Maintenance Fees Paid Through the BLM Pay Portal
(by Date Paid)

Page 269 Of 316

CBS Receipt: 4237303

Printed For Lead File # AMC429993

Agency Tracking ID: 1534441715

Assessment Year: 2019

Number of BLM Serial Nr: 1

Paid On: 8/16/2018

Total Amount Paid: \$155.00

Claim Name	BLM Serial No	Lead File No	Amount Paid
GOLDEN DREAM	AMC429993	AMC429993	\$155.00

United States Department of the Interior

Bureau of Land Management
 BUSINESS & SUPPORT SVCS DIV
 ONE N CENTRAL AVE SUITE 800
 PHOENIX, AZ 85004 -4427
 Phone: 602-417-9200

Receipt

No: 4237303

Transaction #: 4352685	
Date of Transaction: 08/16/2018	
CUSTOMER:	
JEFFREY M DUNKIN 12 FETTERS LN RIVERSIDE, WA 98849 US	

LINE #	QTY	DESCRIPTION	REMARKS	UNIT PRICE	TOTAL
1	1.00	LOCATABLE MINERALS / MINING CLAIMS- NOT NEW-UNADJUD, ONE AUTH NO. ONLY / MINING CLAIM MONEY RECEIVED CASES: AMC429993/\$155.00		- n/a -	155.00
TOTAL:					\$155.00

PAYMENT INFORMATION			
NOTE: Items will appear on credit card statement as "BLM O Mining Claim".			
1	AMOUNT:	155.00	POSTMARKED: N/A
	TYPE:	CREDIT CARD	RECEIVED: 08/16/2018
	NAME:	JEFFREY M DUNKIN 12 FETTERS LN RIVERSIDE WA 98849 US	
	CARD NO:	XXXXXXXXXXXX6905	AUTH CODE: 125885
	NAME ON CARD:	JEFFREY M DUNKIN	
	SIGNATURE:		

REMARKS

This receipt was generated by the automated BLM Collections and Billing System and is a paper representation of a portion of the official electronic record contained therein.

Run Date: 08/15/17

Run Time: 12:18 PM

**DEPARTMENT OF THE INTERIOR
BUREAU OF LAND MANAGEMENT
MINING CLAIMS**

MC Maintenance Fees Paid Through the BLM Pay Portal

CBS Receipt: 3934287

Printed For Lead File # AMC429993

Agency Tracking ID: 1502605666

Assessment Year: 2018

Number of BLM Serial Nr: 1

Paid On: 08/13/2017

Total Amount Paid: \$155.00

Claim Name	BLM Serial No	Lead File No	Amount Paid
GOLDEN DREAM	AMC429993	AMC429993	\$155.00

**United States Department of the Interior
Bureau of Land Management
BUSINESS & SUPPORT SVCS DIV
ONE N CENTRAL AVE SUITE 800
PHOENIX, AZ 85004 -4427
Phone: 602-417-9200**

Receipt

No: 3934287

Transaction #: 4043886	
Date of Transaction: 08/13/2017	
CUSTOMER:	
JEFFREY M DUNKIN 12 FETTERS LN RIVERSIDE, WA 98849 US	

LINE #	QTY	DESCRIPTION	REMARKS	UNIT PRICE	TOTAL
1	1.00	LOCATABLE MINERALS / MINING CLAIMS- NOT NEW-UNADJUD, ONE AUTH NO. ONLY / MINING CLAIM MONEY RECEIVED CASES: AMC429993/\$155.00		- n/a -	155.00
TOTAL:					\$155.00

PAYMENT INFORMATION				
NOTE: Items will appear on credit card statement as "BLM O Mining Claim".				
1	AMOUNT:	155.00	POSTMARKED:	N/A
	TYPE:	CREDIT CARD	RECEIVED:	08/13/2017
	NAME:	JEFFREY M DUNKIN 12 FETTERS LN RIVERSIDE WA 98849 US		
	CARD NO:	XXXXXXXXXXXX6905	AUTH CODE:	083087
	NAME ON CARD:	JEFFREY M DUNKIN		
	EXPIRES:	08/2019		
	SIGNATURE:			

REMARKS

This receipt was generated by the automated BLM Collections and Billing System and is a paper representation of a portion of the official electronic record contained therein.

Run Date: 09/08/16

Run Time: 12:27 PM

**DEPARTMENT OF THE INTERIOR
BUREAU OF LAND MANAGEMENT
MINING CLAIMS**

MC Maintenance Fees Paid Through the BLM Pay Portal

CBS Receipt: 3637785

Printed For Lead File # AMC429993

Agency Tracking ID: 1471864710

Assessment Year: 2017

Number of BLM Serial Nr: 1

Paid On: 08/22/2016

Total Amount Paid: \$155.00

Claim Name	BLM Serial No	Lead File No	Amount Paid
GOLDEN DREAM	AMC429993	AMC429993	\$155.00

United States Department of the Interior
Bureau of Land Management
 BUSINESS & SUPPORT SVCS DIV
 ONE N CENTRAL AVE SUITE 800
 PHOENIX, AZ 85004 -4427
 Phone: (602) 417-9200

Receipt

No: 3637785

Transaction #: 3741671	
Date of Transaction: 08/22/2016	
CUSTOMER:	
JEFFREY M DUNKIN 12 FETTERS LN RIVERSIDE, WA 98849 US	

LINE #	QTY	DESCRIPTION	REMARKS	UNIT PRICE	TOTAL
1	1.00	LOCATABLE MINERALS / MINING CLAIMS- NOT NEW-UNADJUD, ONE AUTH NO. ONLY / MINING CLAIM MONEY RECEIVED CASES: AMC429993/\$155.00		- n/a -	155.00
TOTAL:					\$155.00

PAYMENT INFORMATION				
NOTE: Items will appear on credit card statement as "BLM O Mining Claim".				
1	AMOUNT:	155.00	POSTMARKED:	N/A
	TYPE:	CREDIT CARD	RECEIVED:	08/22/2016
	NAME:	JEFFREY M DUNKIN 12 FETTERS LN RIVERSIDE WA 98849 US		
	CARD NO:	XXXXXXXXXXXX6905	AUTH CODE:	090276
	NAME ON CARD:	JEFFREY M DUNKIN		
	EXPIRES:	08/2019		
	SIGNATURE:			

REMARKS

This receipt was generated by the automated BLM Collections and Billing System and is a paper representation of a portion of the official electronic record contained therein.

FEE# 2015052835

OFFICIAL RECORDS
OF MOHAVE COUNTY
CAROL MEIER,
COUNTY RECORDER



12/01/2015 09:15 AM Fee: \$10.00

PAGE: 1 of 2

Amc429993

NOTICE OF INTENTION TO HOLD MINING CLAIMS/SITES

When Recorded Return Document to:

JEFF DUNKIN
12 FETTERS LN
RIVERSIDE, WA 98849

RECEIVED
LM AVALANCH OFFICE
2015 DEC 10 P 3:11
PHOENIX, ARIZONA

Check here if this is a change of address.

Telephone: _____

E-mail Address jeffdunkin97504@yahoo.com

I (We) intend to hold the claims(s) and/or site(s) listed below for the calendar year 20 15, and I (We) have filed or will file a Notice of Intent to Hold in the county where the claim (s) is located:

Reason for filing a Notice of Intent to Hold instead of an assessment work filing (check one):

- Maintenance fee was paid to maintain claim(s) during this assessment year.
- Mill or tunnel sites.
- Claim(s) was located during the current assessment year.
- BLM has deferred assessment work (attach copy of decision granting deferment, or pending petition for deferment including date petition was filed.)

Line No.	AMC NUMBER	CLAIM / SITE NAME	COUNTY RECORDER DATA	TWP	RNG	SEC.
1	<u>429993</u>	<u>GOLDEN DREAM</u>		<u>28N</u>	<u>18W</u>	<u>8</u>
2						
3						
4						
5						
6						
7						
8						
9						
10						

*Document not necessary.
Nothing entered in LR2000.
AT*

NOTICE OF INTENTION TO HOLD MINING CLAIMS/SITES
page 2

RECEIVED
BLM ARIZONA OFFICE
2015 DEC 10 P 3:11
PHOENIX, ARIZONA
BLM
Date
Stamp

1. State of Arizona, County of MOHAVE

2. I (Name) JEFFREY DUNKIN

3. Reside at (Address) 12 FETTERS LN

City RIVERSIDE County OKANOGAN State WA Zip 98849

being duly sworn, depose and say that I am a citizen of the United States, more than eighteen years of age, that all of the facts set forth in this notice, subject to the provisions and penalties of 18 U.S.C. 1001 pertaining to the filing of false, fictitious, or fraudulent statements with the United States, are true and correct according to the best of my knowledge, information and belief.

4. Owner's name and address (If not shown in Items 1-3 above). _____

5. Dated: Dec 1, 2015 Signature: Jeffrey Dunkin

Bureau of Land Management
Arizona State Office
www.az.blm.gov

No. of Claims: _____ x \$10 = _____
Check No: _____ Init. _____
Receipt No.: _____
For BLM Use Only

When Recorded Return Document to:

JEFFREY DUNKIN
12 FETTERS LN.
RIVERSIDE, WA. 98849



FEE# 2015052834

OFFICIAL RECORDS
OF MOHAVE COUNTY
CAROL MEIER,
COUNTY RECORDER



12/01/2015 09:15 AM Fee: \$15.00

PAGE: 1 of 2

Check here is this is a change of address.

Telephone: 509-422-1947

E-mail address: jeffdnkn97504@yahoo.com

AFFIDAVIT OF PERFORMANCE OF ANNUAL WORK

1. State of Arizona, County of MOHAVE ss:

2. I (Name) JEFFREY DUNKIN

3. Reside at (Address) 12 FETTERS LN.

City RIVERSIDE County OKANOGAN

State WA Zip 98849 being duly sworn, depose and say that I am a citizen of the United States, more than eighteen years of age, and that all of the facts set forth in this affidavit, subject to the provisions and penalties of 18 U.S.C. 1001 pertaining to the filing of false, fictitious, or fraudulent statements with the United States, are true and correct according to the best of my knowledge, information and belief.

4. Owner's name and address (If not shown in Items 1-3 above).

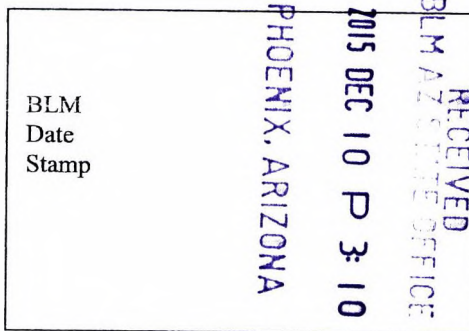

5. That I am personally acquainted with the mining claim(s). The work and improvements were made by and at the expense of the owner(s) of said claim(s). Said contiguous group of claims, listed on this document, are situated in the

(optional) Mining District; _____ County, Arizona.

Line No.	AMC NUMBER	CLAIM/SITE NAME	COUNTY RECORDER DATA	TWP	RNG	SEC
1	429993	GOLDEN DREAM		28N	18W	8
2						
3						
4						
5						
6						

RECEIVED
BLM AZ STATE OFFICE

2015 DEC 10 P 3:11
PHOENIX, ARIZONA

BLM
Date
Stamp

7						
8						
9						
10						

6. That between the dates starting at 12 o'clock noon on September 1, 20 15 and ending at 12 o'clock noon on September 1, 20 16 at least \$ 300.- dollars worth of work and improvements were done and performed upon said claim(s) or upon one or more of a contiguous group of claims for the benefit of all, wholly or partly outside of a contiguous group of claims for the benefit of all, not including the location work.

7. That the following persons were employed to perform the work and improvements described herein: _____

8. That the work and improvements performed were: CLEARING OF ROADS & WASH AREAS TO PROVIDE ACCESS

9. Dated: 12/1/2015 Signature: *Jeffrey Dinkler*

SUBSCRIBED AND SWORN TO before me, a Notary Public, this _____ day of _____ 20 _____

By: _____

Notary Public _____

My Commission Expires _____

Bureau of Land Management
Arizona State Office
www.az.blm.gov

No. of Claims: <u>1</u> x \$10 = _____
Check No.: _____ Init. _____
Receipt No.: _____
For BLM Use Only

Form: MCF108
Revised Jan. 2006
Page 2 of 2

T. DUNKIN
12 FETTERS LN.
RIVERSIDE, WA

RECEIVED
98079
AZ STATE OFFICE

2015 DEC 10 P 3:09

PHOENIX, ARIZONA

LAS VEGAS NV 890

07 DEC 2015 PM 4 L



BLM
ONE NORTH CENTRAL AVE. ST. 800
PHOENIX, AZ
85004-4427

85004442700



T. DUNKIN
12 FETTERS LN.
RIVERSIDE, WA

RECEIVED
BLM
98049
AZ STATE LETTER

2015 DEC 10 P 3:09

PHOENIX, ARIZONA

LAS VEGAS NV 890

07 DEC 2015 PM 4 L

Happy
Holidays
2015



BLM
ONE NORTH CENTRAL AVE. ST. 800
PHOENIX, AZ
85004-4427

85004442700



**DEPARTMENT OF THE INTERIOR
BUREAU OF LAND MANAGEMENT
MINING CLAIMS**

Run Date/Time: 12/11/2015 07:49 AM

(LIVE) Serial Register Page

Page 1 of

01 05-10-1872;017STAT0091;30USC26,28,34
Case Type 384101: LODE CLAIM
Claim Name: GOLDEN DREAM
Commodity :
Case Disposition: ACTIVE
Required Maintenance Fee: \$155.00

Total Acres
20.660

Serial Number
AMC429993
Lead File Number
AMC429993

Name & Address	Int Rel
DUNKIN JEFFERY 12 FETTERS LN RIVERSIDE, WA 98849-9687	CLAIMANT

Mer Twp	Rng	Sec	Quadrant	District/Field Office	County
14	0280N	0180W	008 NW	KINGMAN FO	MOHAVE

Act Date	Code	Action	Action Remarks	Receipt Number
11/21/2014	403	LOCATION DATE		
11/24/2014	395	RECORDATION NOTICE RECD	1	3174196
08/24/2015	782	MAINTENANCE FEE PAYMENT	2016;\$155	3375741
11/24/2014	484	LOCATION YEAR / MAINTENANCE	2015;\$155	3174196
04/08/2015	669	LAND STATUS CHECKED		
11/24/2014	501	ACCT ADV IN LEAD FILE	AMC429993;	
11/21/2014	404	COUNTY RECORDATION	2014050740;	

Line Nr Remarks



Brown, Pauline <paulinebrown@blm.gov>

Two Forms received on Dec 10, 2015 for AMC429993

1 message

Brown, Pauline <paulinebrown@blm.gov>
To: jeffdnkn97504@yahoo.com

Fri, Dec 11, 2015 at 8:40 AM

Good Morning Sir,

On December 10, 2015, we received Form #MCF108 which is the Affidavit of Performance of Annual Work (POL) form and Form #MCF110 the Notice of Intention to hold mining claims/sites (NOI) form. Apparently you did not include the processing fee of \$10 per claim per document; therefore, the documents will have to be returned to you unrecorded, unless proper payment is received.

According to our records, you do not necessarily need to file the two assessment documents at this time because you paid the maintenance fee payment for 2016 (Receipt #3375741). If you plan to switch to filing a Waiver then you would need to file the NOI. Then the POL would be due with-in the calendar year (Before Dec 30) that you filed for a Waiver. Be mindful that if you qualify for a Waiver, there are rules for filing a Waiver. You can find more information on our public website at www.blm.gov/az.

However, if you still wish to file these two documents, you will be required to pay the \$20 processing fee, either by check, money order or credit card. If you wish to pay by credit card, you can call the BLM at 602-417-9200 and ask for the Accounts dept. Please do mention to them that Robert in the mining claims department already has your POL & NOI affidavits. If you plan to mail in your payment, please include a note that explains why you are sending in \$20. Your paper work will remain here (adjudication dept.) until advised otherwise.

If you have any questions, please call Pauline at 602-417-9360.

Regards,

—

PAULINE BROWN
LAND LAW EXAMINER
BUREAU OF LAND MANAGEMENT
ARIZONA STATE OFFICE
ONE NORTH CENTRAL AVE, STE 800
PHOENIX, AZ 85004-4427
OFFICE: (602) 417-9360
FAX: (602) 417-9490; 602-417-9452
paulinebrown@blm.gov

United States Department of the Interior
Bureau of Land Management
 BUSINESS & SUPPORT SVCS DIV
 ONE N CENTRAL AVE SUITE 800
 PHOENIX, AZ 85004 -4427
 Phone: (602) 417-9200

Receipt

No: 3375741

Transaction #: 3473969	
Date of Transaction: 08/24/2015	
CUSTOMER:	
JEFFREY M DUNKIN 12 FETTERS LN RIVERSIDE, WA 98849 US	

LINE #	QTY	DESCRIPTION	REMARKS	UNIT PRICE	TOTAL
1	1.00	LOCATABLE MINERALS / MINING CLAIMS- NOT NEW-UNADJUD, ONE AUTH NO. ONLY / MINING CLAIM MONEY RECEIVED CASES: AMC429993/\$155.00		- n/a -	155.00
TOTAL:					\$155.00

PAYMENT INFORMATION			
NOTE: Items will appear on credit card statement as "BLM O Mining Claim".			
1	AMOUNT:	155.00	POSTMARKED: N/A
	TYPE:	CREDIT CARD	RECEIVED: 08/24/2015
	NAME:	JEFFREY M DUNKIN 12 FETTERS LN RIVERSIDE WA 98849 US	
	CARD NO:	XXXXXXXXXXXX6905	AUTH CODE: 058556
	NAME ON CARD:	JEFFREY M DUNKIN	
	EXPIRES:	08/2016	
	SIGNATURE:		

REMARKS

This receipt was generated by the automated BLM Collections and Billing System and is a paper representation of a portion of the official electronic record contained therein.

Run Date: 08/27/15

Run Time: 08:15 AM

**DEPARTMENT OF THE INTERIOR
BUREAU OF LAND MANAGEMENT
MINING CLAIMS**

MC Maintenance Fees Paid Through the BLM Pay Portal

CBS Receipt: 3375741

Printed For Lead File # AMC429993

Agency Tracking ID: 1440446114

Number of BLM Serial Nr: 1

Assessment Year: 2016

Paid On: 08/24/2015

Total Amount Paid: \$155.00

Claim Name	BLM Serial No	Lead File No	Amount Paid
GOLDEN DREAM	AMC429993	AMC429993	\$155.00

United States Department of the Interior
Bureau of Land Management
 BUSINESS & SUPPORT SVCS DIV
 ONE N CENTRAL AVE SUITE 800
 PHOENIX, AZ 85004 -4427
 Phone: (602) 417-9200

Receipt

No: 3375741

Transaction #: 3473969	
Date of Transaction: 08/24/2015	
CUSTOMER:	
JEFFREY M DUNKIN 12 FETTERS LN RIVERSIDE, WA 98849 US	

LINE #	QTY	DESCRIPTION	REMARKS	UNIT PRICE	TOTAL
1	1.00	LOCATABLE MINERALS / MINING CLAIMS- NOT NEW-UNADJUD, ONE AUTH NO. ONLY / MINING CLAIM MONEY RECEIVED CASES: AMC429993/\$155.00		- n/a -	155.00
TOTAL:					\$155.00

PAYMENT INFORMATION						
NOTE: Items will appear on credit card statement as "BLM O Mining Claim".						
1	AMOUNT:	155.00	POSTMARKED:	N/A		
	TYPE:	CREDIT CARD	RECEIVED:	08/24/2015		
	NAME:	JEFFREY M DUNKIN 12 FETTERS LN RIVERSIDE WA 98849 US				
	CARD NO:	XXXXXXXXXXXX6905	AUTH CODE:	058556		
	NAME ON CARD:	JEFFREY M DUNKIN				
	EXPIRES:	08/2016				
	SIGNATURE:					

REMARKS

This receipt was generated by the automated BLM Collections and Billing System and is a paper representation of a portion of the official electronic record contained therein.

NOTICE!!

These documents have been scanned!

Do not place un-scanned documents beneath this notice!

Do not remove this notice from this file!

GPO Jacket No. 560-102
Print Order 61540
Rise Business Services, LLC
Job=AZ15 5/10/2019



Box Number= AZ15031



Claim Begin-End: AMC429993-AMC429993

5 Miscellaneous



AZ15031-27

AMC429540-AMC429995

**NO
DOCUMENTS
FOUND**

NO DOCUMENTS FOUND
NO DOCUMENTS FOUND

NOTICE!!

These documents have been scanned!

Do not place un-scanned documents beneath this notice!

Do not remove this notice from this file!

GPO Jacket No. 560-102
Print Order 61540
Rise Business Services, LLC
Job=AZ15 5/10/2019



Box Number= AZ15031



Claim Begin-End: AMC429993-AMC429993

6 Location Notices-Amendments and Supporting Documents



AZ15031-27

AMC429540-AMC429995

**DEPARTMENT OF THE INTERIOR
BUREAU OF LAND MANAGEMENT
MINING CLAIMS**

Run Date/Time: 11/26/2014 12:27 PM

(LIVE) Serial Register Page

Page 1 of 1

01 05-10-1872;017STAT0091;30USC26,28,34
Case Type 384101: LODE CLAIM
Claim Name: GOLDEN DREAM
Commodity :
Case Disposition: ACTIVE
Required Maintenance Fee: \$155.00

Total Acres
20.660

Serial Number
AMC429993
Lead File Number
AMC429993

Name & Address	Int Rel
DUNKIN JEFFERY 12 FETTERS LN RIVERSIDE, WA 98849-9687	CLAIMANT

Mer Twp	Rng	Sec	Quadrant	District/Field Office	County
14	0280N	0180W	008 NW	KINGMAN FO	MOHAVE

Act Date	Code	Action	Action Remarks	Receipt Number
11/21/2014	403	LOCATION DATE		
11/24/2014	395	RECORDATION NOTICE RECD	1	3174196
11/24/2014	484	LOCATION YEAR / MAINTENANC	2015;\$155	3174196
11/24/2014	501	ACCT ADV IN LEAD FILE	AMC429993;	
11/21/2014	404	COUNTY RECORDATION	2014050740;	

Line Nr Remarks

MINING CLAIM STATUS REPORT

Data Entered: 11/24/14 RAM

MTP Checked By: EG

GEO Checked By: EG

LEAD SERIAL NUMBER: AMC 429993 thru AMC _____

NUMBER OF CLAIMS & TYPE:

- 1 LODE
- _____ PLACER
- _____ ASSOCIATION PLACER
- _____ MILL SITE
- _____ TUNNEL SITE

CHARGES:

- Location Fee @ \$37 = \$ 37
- Processing Fee @ \$20 = \$ 20
- Maintenance Fee @ \$155 = \$ 155
- Add'l Maint Fee for Assoc Placer = \$ _____
- SUBTOTAL** \$ 212
- Other Fees \$ _____
- Other Fees \$ _____
- TOTAL** \$ 212.00

TOTAL ACREAGE: _____ Per Claim
(Placer Only)

NUMBER OF LOCATORS: 1

DOCUMENTS RECEIVED VIA : Over-the-Counter Mail TIMELY FILED: Yes No

LEGAL DESCRIPTION: T 28N R 18W SEC 8

T _____ R _____ SEC _____

T _____ R _____ SEC _____

T _____ R _____ SEC _____

T _____ R _____ SEC _____

BLM FOREST SERVICE SUBJ TO PL 359: Yes No
WILDERNESS AREA

SPLIT ESTATE: N/A SX PX OTHER
SRHA Was proper Notice filed if located on SHRA Land? Yes No

RECONVEYED MINERALS ON BLM LAND REQUIRE OPENING ORDER FROM 1944 TO 1993:
Open to Entry On _____ N/A

COMMENTS/STATUS: VOID PARTIALLY VOID PVT MINERALS WITHDRAWN LANDS
OTHER

Claimant acknowledges that portions of the following claim(s) site(s) may be void or voidable.

Printed Name of Claimant _____ Signature of Claimant _____

*****FINAL ADJUDICATION*****

DATE 4/8/15 INITIALS HT

AMC 429993

2

FEE# 2014050740

OFFICIAL RECORDS
OF MOHAVE COUNTY
CAROL MEIER,
COUNTY RECORDER



11/21/2014 03:54 PM Fee: \$10.00

PAGE: 1 of 2

Return to

Jeffery Dunkin

12 Fetters Ln

Riverside, WA 98849

Notice of Lode Mining Claim Location

Locator:

Jeffery Dunkin

12 Fetters Ln

Riverside, WA 98849

Claim Name: Golden Dream

Date of location: Nov. 21, 2014

RECEIVED
S.L.M. / AZ STATE OFFICE
2014 NOV 24 A 9: 23
PHOENIX, AZ

The Lode Mining Claim is 1500 feet long and 600 feet wide. The location monument is 300 feet from the South End and 1200 from the North End Center.

The claim trends generally from the South, South, East to the North, North, West. The location Monument is in the NW1/4, SE1/4, NW1/4 of Section 8, Township 28N, Range 18W, Gila and Salt River Meridian. The LM is also 1734' E then 3370' N from the South West corner of Section 8, Township 28N, Range 18W.

<u>Location</u>	<u>Markings</u>	<u>Az. State plane grid (West NAD83)</u>
No.1: NW Corner	Metal tag on post	1,759,233.8 feet N 556,131.3 Feet E
No.2: SW Corner	Metal tag on post	1,757,832.9 feet N 556,663.6 Feet E
No.3: SE Corner	Metal tag on post	1,758,044.8 Feet N 557,226.4 Feet E
No.4: NE Corner	Metal tag on post	1,759,445.7 Feet N 556,694.1 Feet E

Location monument is a 2" x 2" x 5" foot wooden post. Corner and end center monuments are the same.

Signature

Jeffery Dunkin
Jeffery Dunkin, locator

Karen Jackson

Witness:

AMC429993

Map of Golden Dream Lode Claim

Section 8, T28N, R18W
Gold Basin Mining District
Mohave County, Arizona

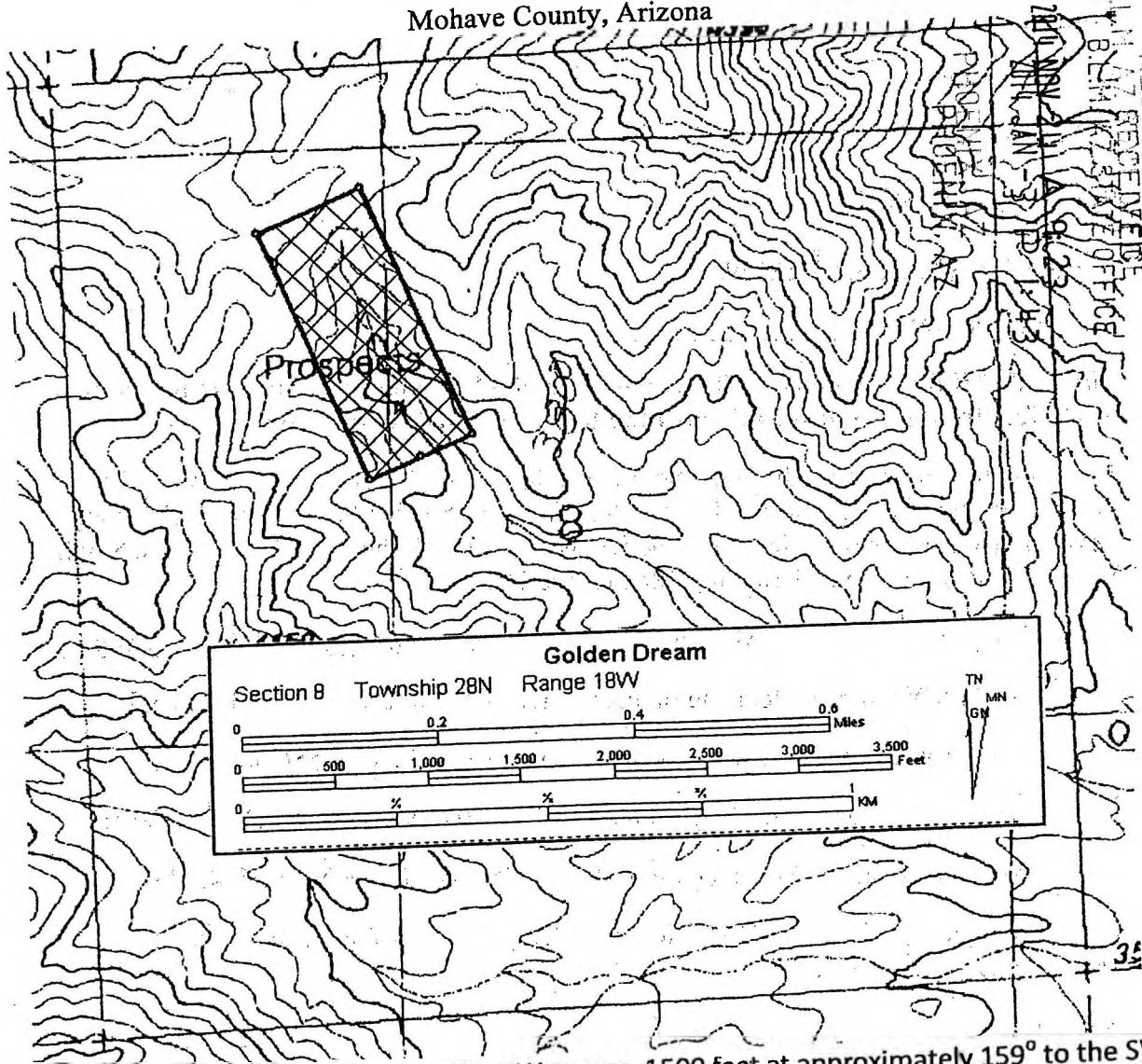

The Claim is delineated thusly: From the NW corner, 1500 feet at approximately 159° to the SW corner, then 600 feet at approximately 69° to the SE Corner, then 1500 feet at approximately 339° to the NE corner, then 600 feet at approximately 249° to the point of beginning.

RECEIVED
BLM AZ RECEIVED
OFFICE
2010 JAN 23 PD 143

~~AMC 429993~~

AMC 429993

Input Parameters for Geographic Report with Land

System Id = CR

Admin State = AZ

Geo State =

Casetype Begins With

Case Disp Txt = AUTHORIZED, CANCELLED, EXPIRED, PENDING, REJECTED, RELINQUISHED, VOID, WITHDRAWN

Mer Twp Rng =

Section =

Mtrs = 14 0280N 0180W 008, 14 0280N 0180W 999

Commodity =

Commodity Txt =

Pending Org =

Pend Org Decode =

Total Rows Returned: 0

